

Fayerdale Hall Conference Center Floor Plan

Fairy Stone State Park

967 Fairystone Lake Dr., Stuart, VA 24171 (276) 930-2424 fairystone@dcr.virginia.gov

- Floor plan must be returned to the park office at least 14 days prior to your event. Requests for rental equipment or floor plan arrangement will not be honored within 14 days of your event.
- Please sketch location where tables and chairs are needed on floor plan below. Note: Floor plan not to scale.

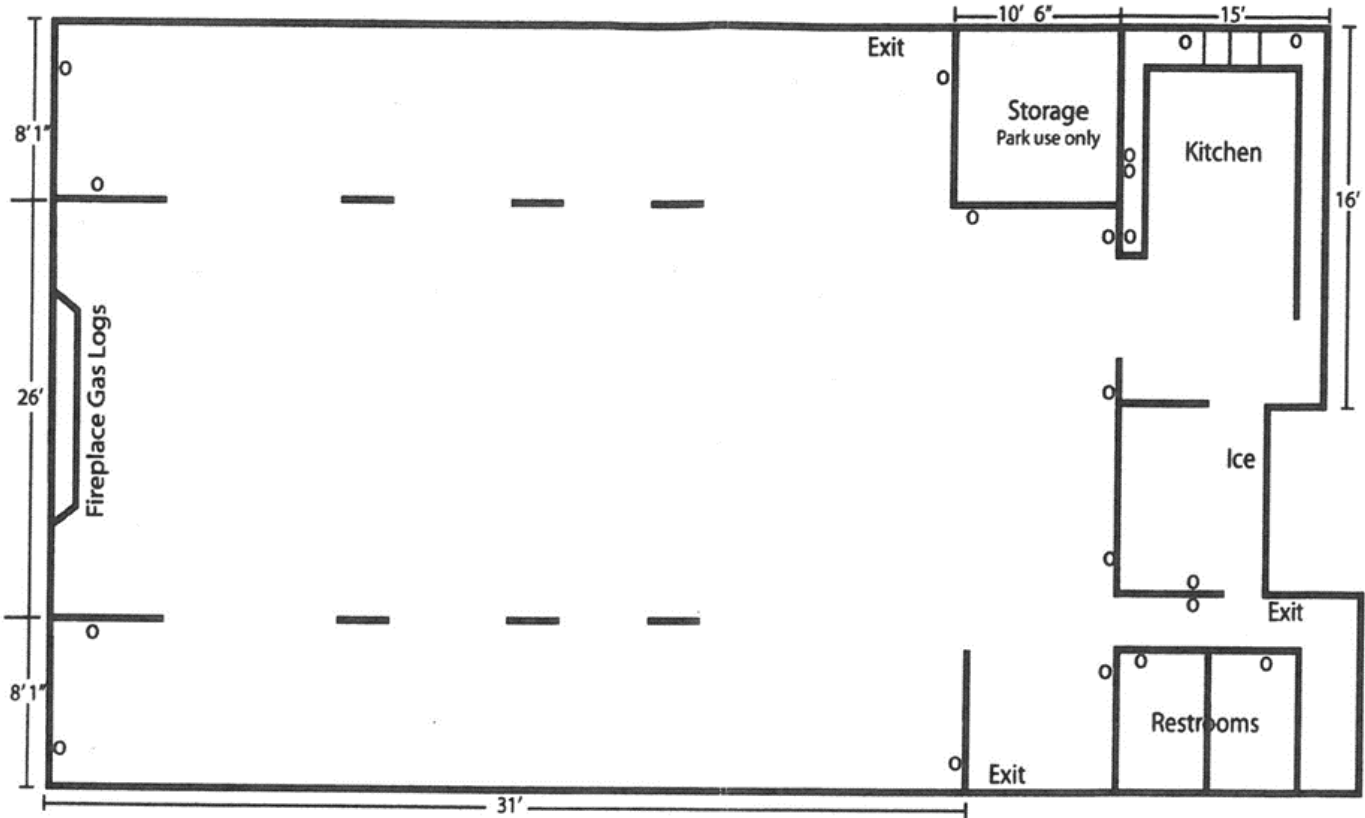

Great room dimensions: Approx. 42' W x 41" L | On floor plan, ○ = electrical outlet

	# Available	# Needed
6' Rectangular Tables	19	
4' Round Tables	5	
4' Rectangular Tables	2	
Chairs	130	

Equipment Rentals	Cost	Needed?
Tent Side Panels (available 4/1—10/31)	\$60	
TV w/ Blu-ray/DVD	Free	
Flip Chart	Free	
Podium	Free	

Name: _____

Reservation Confirmation Number: _____

Date of Event: _____

