

Fayerdale Hall Conference Center Floor Plan

Fairy Stone State Park

967 Fairystone Lake Dr., Stuart, VA 24171 (276) 930-2424 fairystone@dcr.virginia.gov

- Floor plan must be returned to the park office at least 14 days prior to your event. Requests for rental equipment or floor plan arrangement will not be honored within 14 days of your event.
- Please sketch location where tables and chairs are needed on floor plan below. Note: Floor plan not to scale.

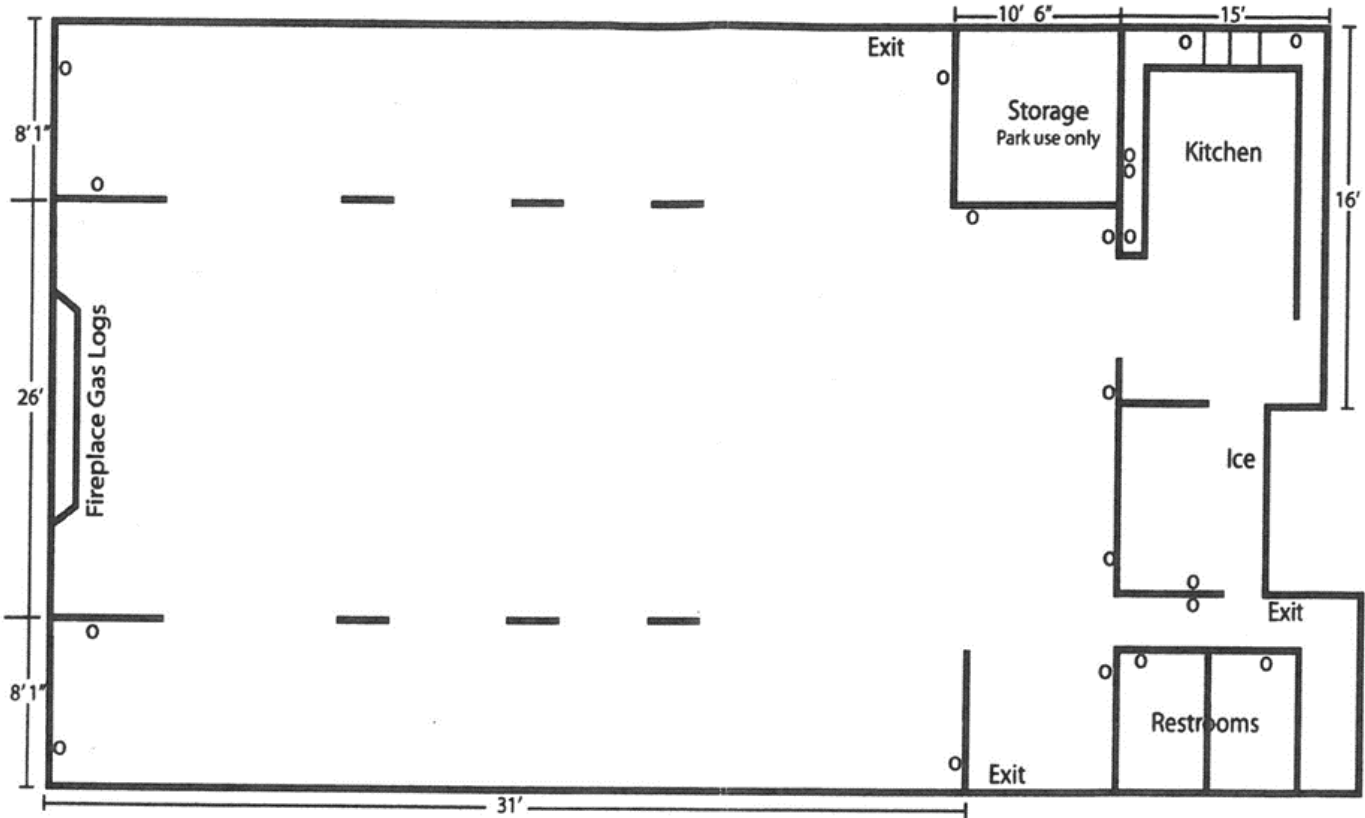

Great room dimensions: Approx. 42' W x 41" L | On floor plan, ○ = electrical outlet

	# Available	# Needed
6' Rectangular Tables	20	
4' Round Tables	15	
4' Rectangular Tables	2	
Chairs	130	

Equipment Rentals	Cost	Needed?
Tent Side Panels (available 4/1—10/31)	\$60	
Projector/Screen	\$20	
Flip Chart	Free	
Podium	Free	
Ladder	Free	

Name: _____

Reservation Confirmation Number: _____

Date of Event: _____

